

VARIANCE® P



ASSEMBLY GUIDE

GLASS CLADDING SYSTEM



ASSEMBLY
GUIDE VIDEO

ORDER CONFORMITY

We advise you to read this manual completely and carefully before working on the equipment.

Using the delivery note, check the conformity of the delivery before any other intervention.

ACTIVATE YOUR PRODUCT WARRANTY

Register directly on our website
www.sadev.com/maintenance-and-warranty



Description of the kit (for 1 glass panel held in 4 points)

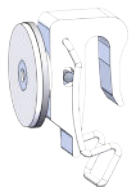

Weight hook
2 copies



Wind hook
2 copies



Anti-translation device
1 copie



Ring
4 copies



Screw
4 copies



Cap
4 copies

Description of the kit (for 1 glass panel held in 6 points)

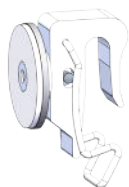

Weight hook
2 copies



Wind hook
4 copies



Anti-translation device
1 copie



Ring
6 copies



Screw
6 copies



Cap
6 copies

It is possible to have a kit for glass panel held in 8 points.

RECOMMANDATIONS

The installation of the Variance P fastening system must comply with these installation instructions, as well as with the usual safety precautions. Any modification or degradation of SADEV's products disengage the responsibility of our company.

Available on [sadev.com](https://www.sadev.com)

SUMMARY

A	CHECK THE VERTICAL STRUCTURE (PRIMARY)	04
B	ASSEMBLY OF THE HORIZONTAL STRUCTURE (SECONDARY)	05
C	FIXING THE HOOKS ON THE GLASS PANEL	07
D	ASSEMBLY OF GLASS PANELS	10
E	FASTENING OF THE CLIP	12
F	REPLACEMENT OF A GLASS PANEL MAINTENANCE	13

Tools required for assembly

- **DRILL/DRIVER**
- **SCREWS ADAPTED TO THE MATERIAL OF THE PRIMARY FRAMEWORK ACCORDING TO THE CSTB 3194 SPECIFICATIONS** e.g.: self-drilling screw Ø 5.5 mini for aluminium)
- **TIGHTENING TOOL AND TORQUE CONTROL** according to the type of anchor used
- **TORQUE CONTROL: TORQUE WRENCH WITH CHC TIP**
Tightening torque: 5 Nm
- **LEVEL**

HOW TO MADE A WATER DRAINAGE

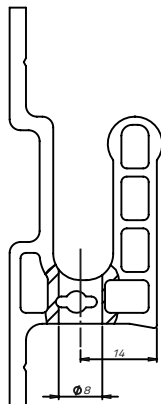

The drainage of the Variance rails is carried out by drilling holes of Ø 8 mm every 1000 mm in the aluminium profile according to the diagram above.

A CHECK THE VERTICAL STRUCTURE (PRIMARY)



1 - The primary structure must be in accordance with the dimensioning study previously carried out.

Check the leveling of each element.

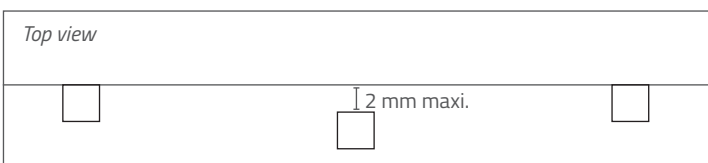

The coplanarity of the uprights shall be checked between adjacent uprights with a maximum permissible deviation of 2 mm.

B ASSEMBLY OF THE HORIZONTAL STRUCTURE (SECONDARY) STRUCTURE

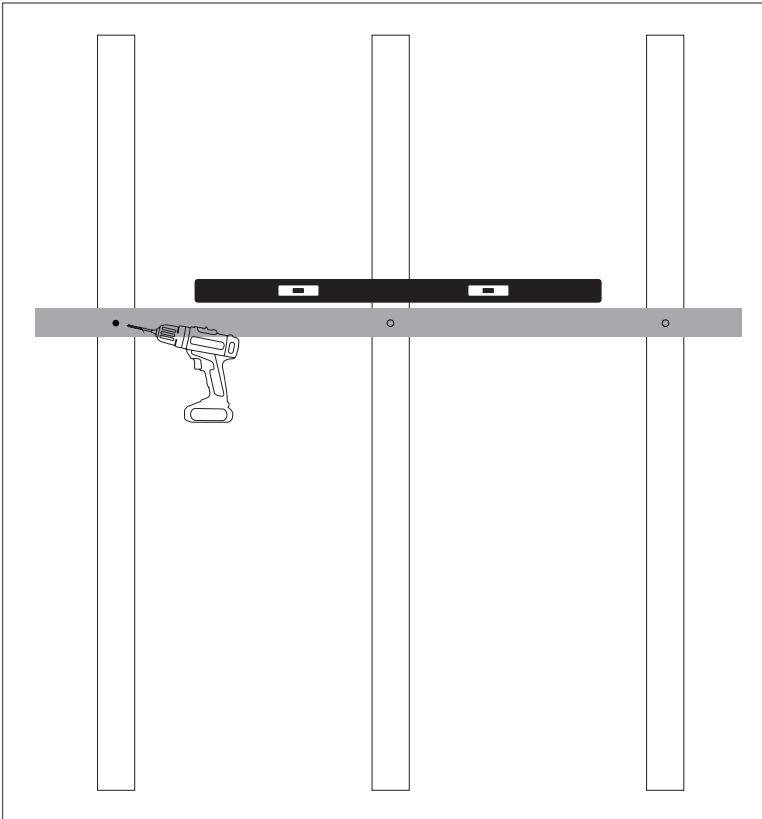

1 - According to the study of calpinage which was carried out to you, fix the rails by controlling their levelling.

INFORMATION

Possible supports: concrete, wood, metal, others...

The support must be able to support the loads induced by the balustrade.

B ASSEMBLY OF THE HORIZONTAL STRUCTURE (SECONDARY)

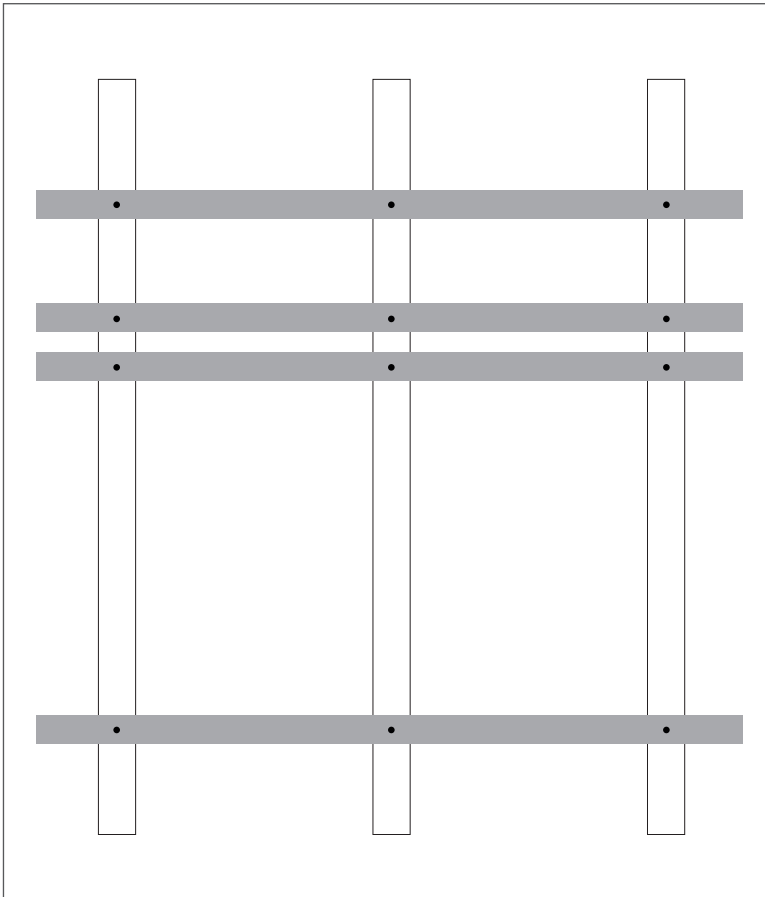

2 - Attach the elements forming the horizontal (secondary) structure.
Check the level of each element.

C FIXING THE HOOKS ON THE GLASS PANEL

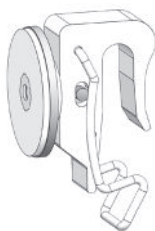
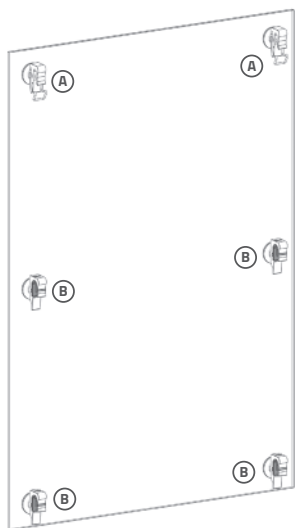
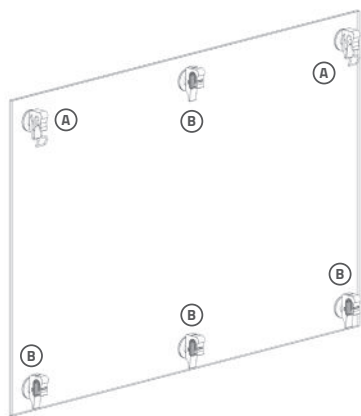
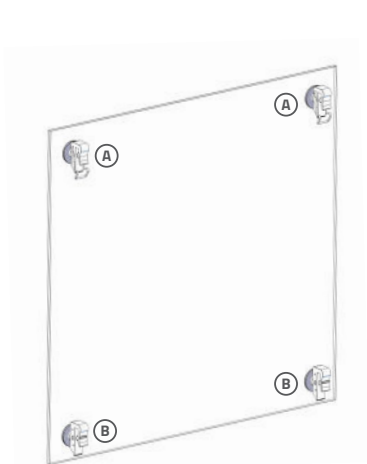

(A) HOOK WEIGHT



(B) WIND HOOK

C FIXING THE HOOKS ON THE GLASS PANEL

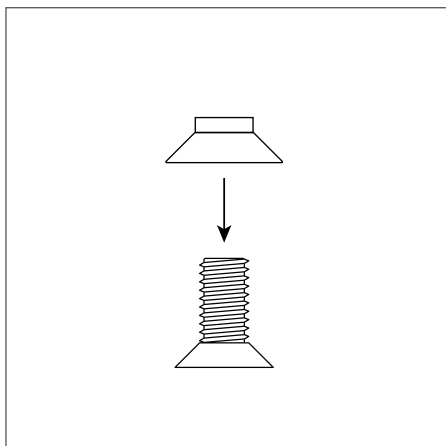

1 - Insert the ring on the screw.

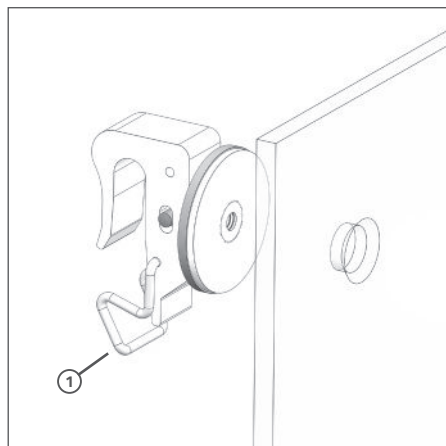

2 - Position the hook on the back of the glass panel. The anti-lift clip ① must be at the bottom.

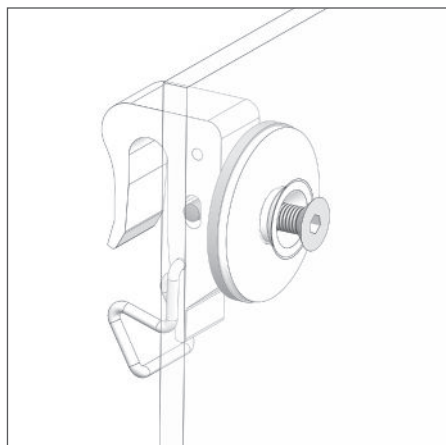

3 - Insert the ring and the screw in the hole of the panel. The screw is glued with threadlocker (e.g. type loctite blue 243).

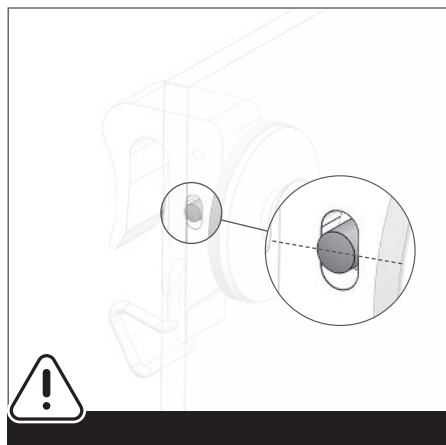

CAUTION:
Before tightening each hook, make sure the pin is in the middle of the oblong.

C FIXING THE HOOKS ON THE GLASS PANEL

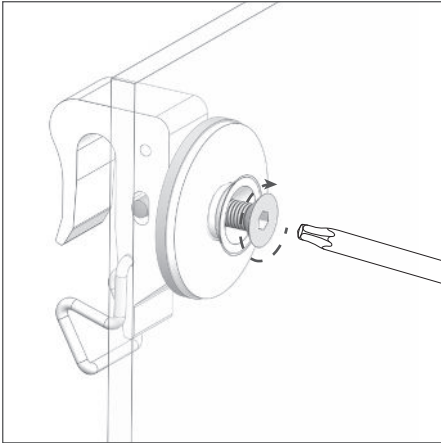

4 - Tight the screw to a torque of 5 Nm while holding the hook vertically.

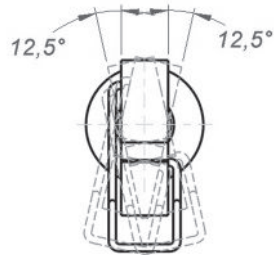

After tightening the screw, make sure that the hook remains angularly free.

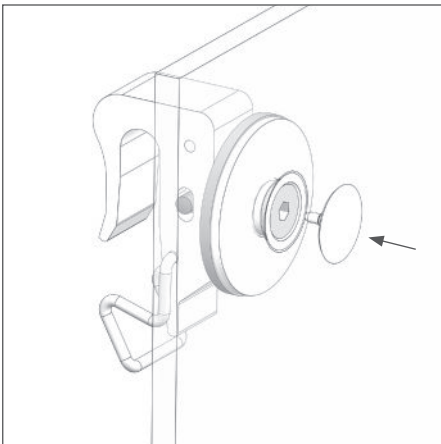

5 - Apply a drop of threadlocker on the axis of the cap, insert it in the center of the screw and press.

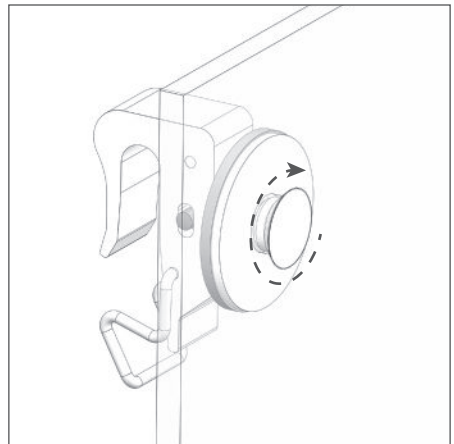

6 - Make a quarter turn to lock it. Repeat the operation for all the hooks. (weight hooks and wind hooks).

D ASSEMBLY OF GLASS PANELS

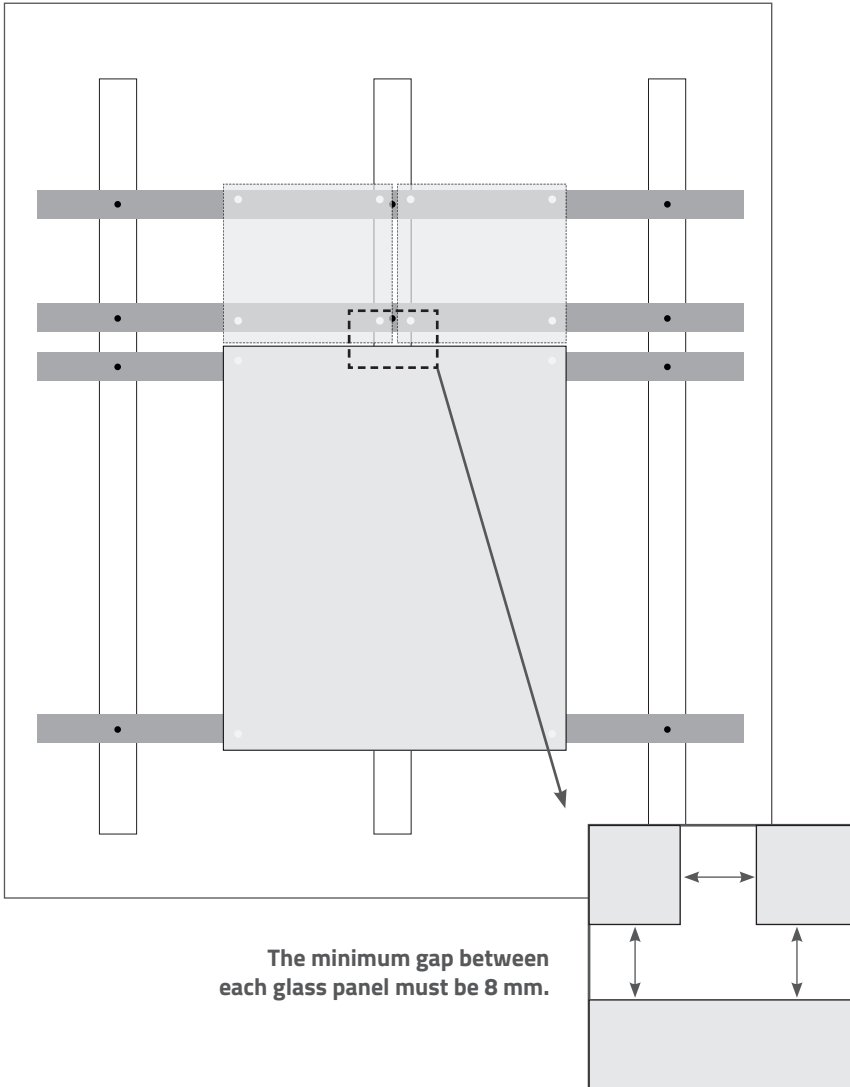

The minimum gap between each glass panel must be 8 mm.

D ASSEMBLY OF GLASS PANELS

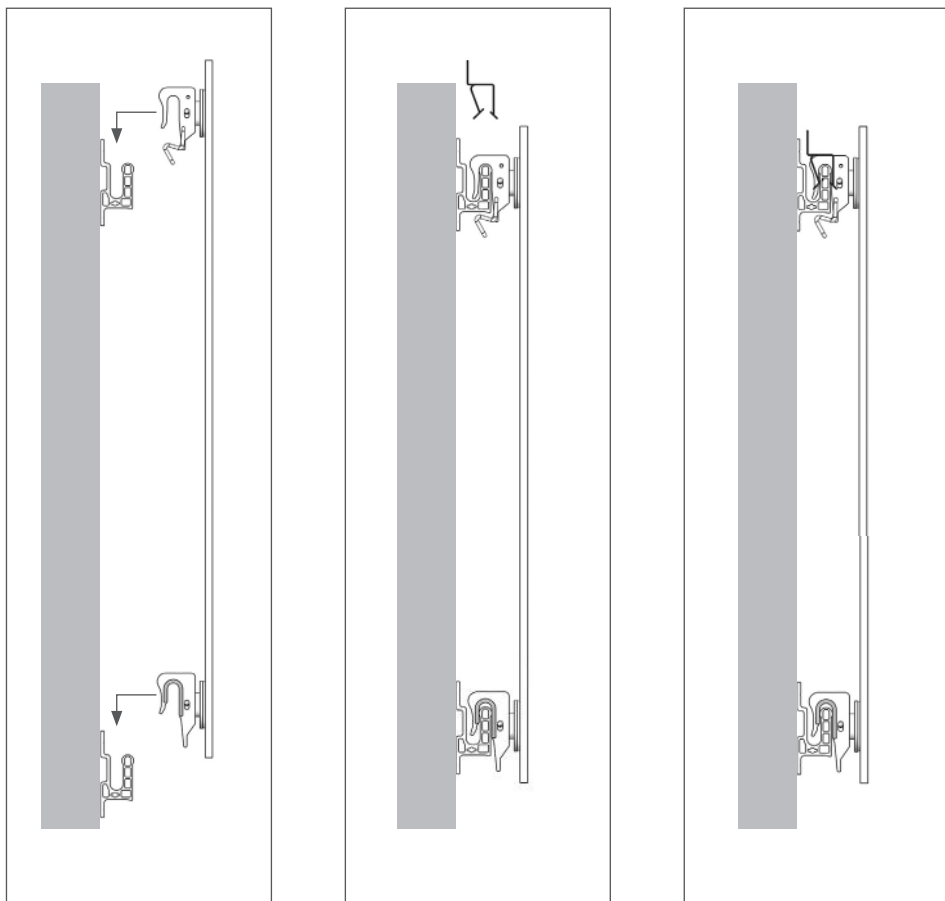

1 - Hang your panel on the rails starting with the bottom panels.

E FASTENING OF THE ANTI TRANSLATION DEVICE

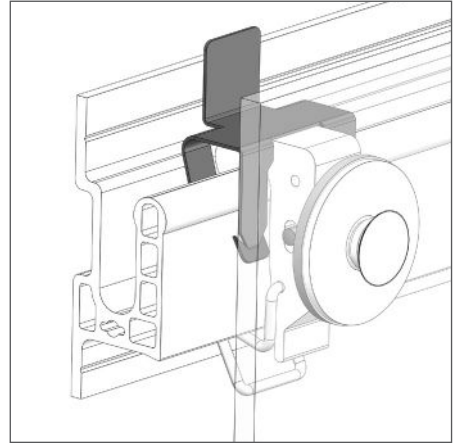
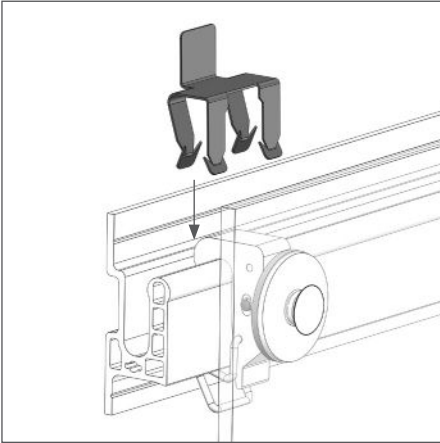

1 - To lock the panel horizontally, insert the staple on one of the weight hooks with a mallet.

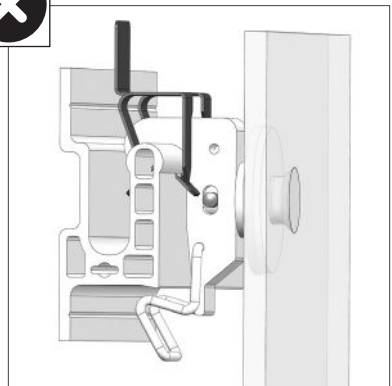
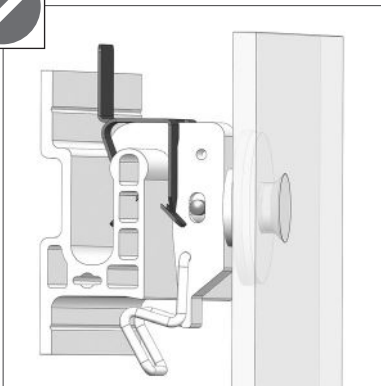

CAUTION:
The clip must be in contact with the hook.

F REPLACEMENT OF A GLASS PANEL **MAINTENANCE**

To make the change, disassemble the hooks from the panel by removing the caps, screws and bushings. The hooks remain in place on the rails.

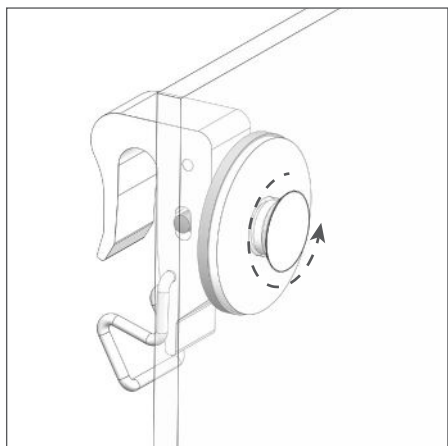

1 - Remove the cap by unscrewing it.

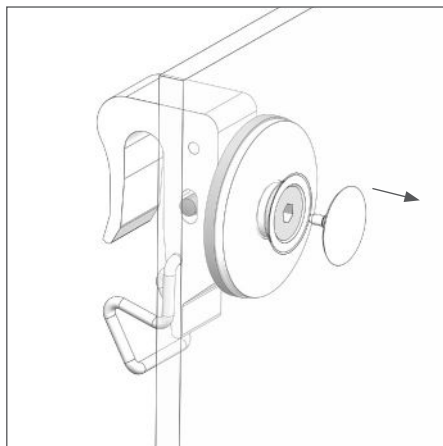

2 - Remove it from the screw.

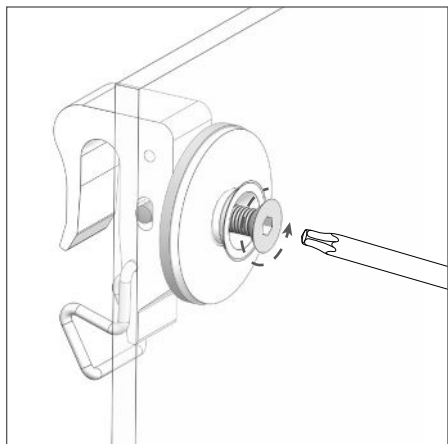

3 - Loosen the screw.

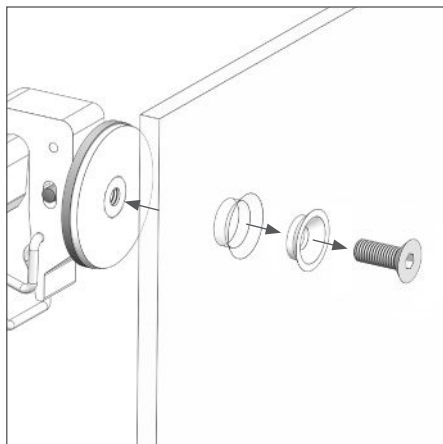

4 - Remove the screw and the countersunk ring (the hooks remain on the arm).

F REPLACEMENT OF A GLASS PANEL MAINTENANCE

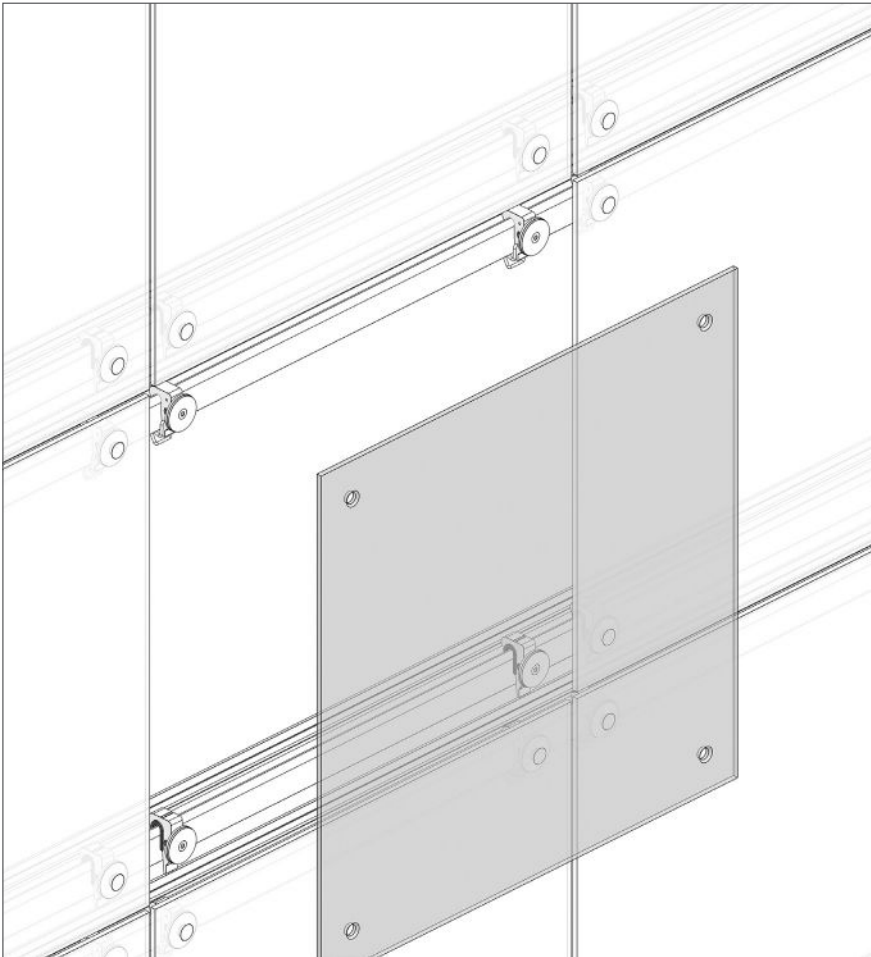

5 - Reposition the panel and reassemble the rings, screws and caps by repeating the steps on C-3 page 8.

Notes

.....
.....
.....
.....
.....
.....
.....
.....
.....
.....
.....
.....
.....
.....
.....
.....
.....
.....
.....
.....
.....
.....
.....
.....
.....
.....
.....
.....
.....
.....
.....
.....
.....
.....
.....
.....
.....
.....
.....
.....
.....
.....
.....
.....
.....
.....
.....
.....
.....
.....
.....

VARIANCE® P

ASSEMBLY GUIDE GLASS CLADDING SYSTEM

Available [sadev.com](https://www.sadev.com) 



76 Chemin des Poses | 74330 POISY | FRANCE
Tél. : +33 (0)4 50 08 39 00 | info@sadev.com | www.sadev.com